

CULMO SERIES – Indirect Dome

HIDS Series shine from a conical surface providing illumination from all angles. The illumination is able to provide images without shadows.

CULMO SERIES – Angular Dark Field

HDLR Series is an illuminator with LEDs arranged in one row. The illumination provides a darkfield effect which able to highlight surface such as scratches and pits.

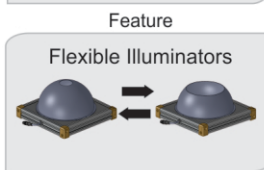
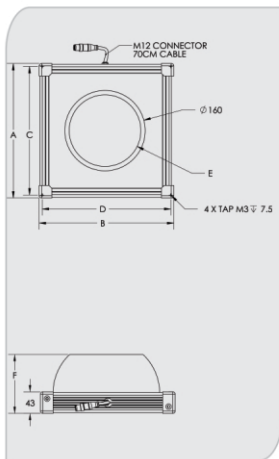
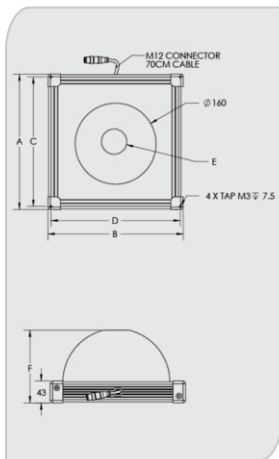
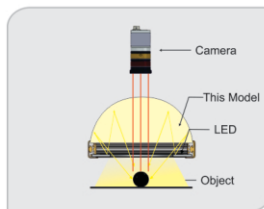
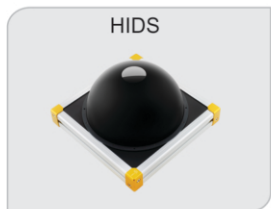

DIMENSIONS (MM)										
MODEL	A	B	C	D	E	F	COLOR	VOLTAGE/ WATT	CURRENT	WEIGHT (g)
HIDS-00-200-X	268	268	256	256	Ø50	143.6	●●●○	24V /18.72W 24V /17.5W	780mA 728mA	2160
HDLR-00-200-X	268	268	256	256	Ø142.6	117.4	●●●○	24V /18.72W 24V /17.5W	780mA 728mA	2070