

# Miniature Low Profile Tension & Compression **LOAD CELL**

## DDE Series



- Capacities 250N to 50kN
- Tension and Compression
- Sealed to IP65
- Low Profile and Very Compact
- Integral Male Threads for In-Line Mounting
- Low Deflection
- High Natural Frequency
- Robust Construction
- 3 YEAR WARRANTY

### Options Available

Non-Standard sizes available on request

Other ranges available on request

Shunt Calibration Facility

Spherical Seating Rod End Bearings

Female Adaptors available on request

Compression Fittings available on request

### **DESCRIPTION**

The DDE range of low profile load cells is designed for the measurement of tensile or compressive forces.

The DDE design enables in-line mounting of the load cell in a variety of industrial, research and development applications. Its compact size makes it advantageous in applications where it is not possible to fit conventional load cells, i.e.. 'S' type load cells.

The low deflection and high natural frequency of the DDE offers particular benefits in material testing and cable tension monitoring applications.

The DDE, as with all other Applied Measurements sensors, can be supplied complete with monitoring/control electronics and calibrated as a system (please refer to the Instrumentation datasheets).

Transducer Specialists...

## APPLIED MEASUREMENTS LIMITED

3 MERCURY HOUSE - CALLEVA PARK - ALDERMASTON - BERKSHIRE - RG7 8PN - UK

Tel: (+44) 0118 981 7339 Fax: (+44) 0118 981 9121 email: [info@appmeas.co.uk](mailto:info@appmeas.co.uk) Internet: [www.appmeas.co.uk](http://www.appmeas.co.uk)



# SPECIFICATION

**Wiring Schematic Diagram**

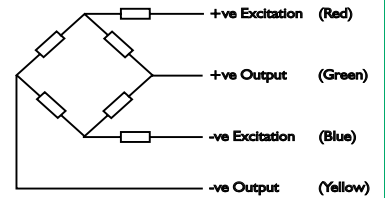

CHARACTERISTICS	DDE	UNITS
<b>Rated Capacities:</b>	250, 500, 1000, 2000, 5000, 10000, 20000, 50000	<b>N</b>
<b>Rated Output:</b>	2.0 nominal	<b>mV/V</b>
<b>Non-Linearity:</b>	<0.25	<b>±% of Rated Output</b>
<b>Hysteresis:</b>	<0.30	<b>% of Rated Output</b>
<b>Zero Balance:</b>	<1.0	<b>±% of Rated Output</b>
<b>Temperature Range Operating:</b>	-20 to +80	<b>°C</b>
<b>Compensated:</b>	0 to +70	<b>°C</b>
<b>Temperature Effect On Output:</b>	<0.005	<b>±% of Applied Load/ °C</b>
<b>On Zero:</b>	<0.005	<b>±% of Rated Output/ °C</b>
<b>Safe Overload:</b>	150	<b>% of Rated Capacity</b>
<b>Ultimate Overload:</b>	200	<b>% of Rated Capacity</b>
<b>Excitation Recommended:</b>	10	<b>Volts AC or DC</b>
<b>Maximum:</b>	15	<b>Volts AC or DC</b>
<b>Input Impedance:</b>	700	<b>Ohms</b>
<b>Output Impedance:</b>	700	<b>Ohms</b>
<b>Insulation Impedance:</b>	>500	<b>Megaohms</b>
<b>Construction:</b>	Stainless Steel	
<b>Environmental Protection:</b>	IP65	
<b>Cable:</b>	2 Metre 4 Core Screened	

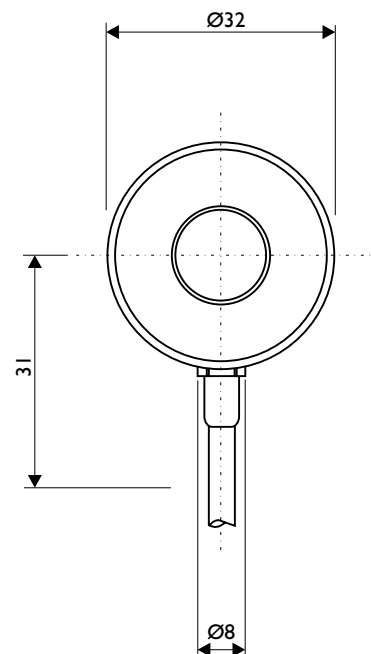
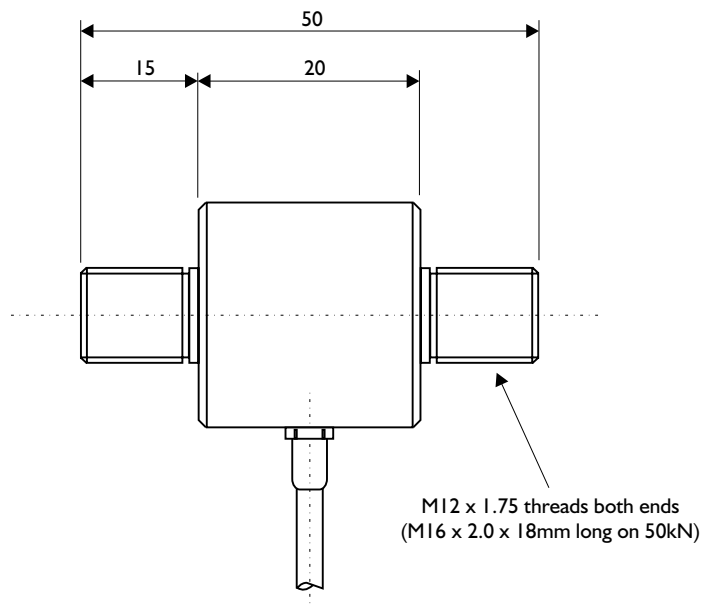

**All dimensions in mm**

## APPLIED MEASUREMENTS LIMITED

Issue 11/06



Continuous product development may result in minor changes to published specifications.