

# Stainless Steel Low Profile Compression **LOAD CELL**

## CBES Series



- Capacities 50kg to 50000kg
- Sealed to IP67
- Low Profile
- Integral Load Button
- Robust Construction
- 3 YEAR WARRANTY

### Options Available

Standard and Special mounting bases

Full Range of mounting options  
available (consult Factory)

Special sizes available on request

Other ranges available on request

### DESCRIPTION

The CBES is a range of low profile compact load cells and is designed for the measurement of compressive forces.

The CBES is equally suited for both Force Measurement and Weighing applications alike. It's compact size means that it can be fitted in to the smallest of space envelopes and is often retrofitted. In weighing systems, the low height gives an added benefit in that it does not increase the headroom required for vessels and is simple to install.

The CBES as with all the other Applied Measurements sensors can be supplied complete with monitoring/control electronics and calibrated as a system (please refer to the Instrumentation datasheets).

*Transducer Specialists...*

## APPLIED MEASUREMENTS LIMITED

3 MERCURY HOUSE - CALLEVA PARK - ALDERMASTON - BERKSHIRE - RG7 8PN - UK

Tel: (+44) 0118 981 7339 Fax: (+44) 0118 981 9121 email: [info@appmeas.co.uk](mailto:info@appmeas.co.uk) Internet: [www.appmeas.co.uk](http://www.appmeas.co.uk)



# SPECIFICATION

**Wiring Schematic Diagram**

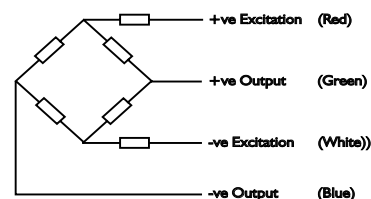

CHARACTERISTICS	CBES	UNITS
<b>Rated Capacities:</b>	50, 100, 200, 500, 1000, 2000, 5000, 10000, 20000, 30000, 50000	kgf
<b>Rated Output:</b>	$2.0 \pm 0.5\%$	mV/V
<b>Non-Linearity:</b>	$<0.15$	$\pm\%$ of Rated Output
<b>Hysteresis:</b>	$<0.15$	% of Rated Output
<b>Repeatability:</b>	$<0.10$	$\pm\%$ of Rated Output
<b>Zero Balance:</b>	$<1.0$	$\pm\%$ of Rated Output
<b>Temperature Range Operating:</b>	-20 to +80	$^{\circ}\text{C}$
<b>Compensated:</b>	-10 to +70	$^{\circ}\text{C}$
<b>Temperature Effect On Output:</b>	$<0.010$	$\pm\%$ of Applied Load/ $^{\circ}\text{C}$
<b>On Zero:</b>	$<0.010$	$\pm\%$ of Rated Output/ $^{\circ}\text{C}$
<b>Safe Overload:</b>	150	% of Rated Capacity
<b>Ultimate Overload:</b>	300	% of Rated Capacity
<b>Excitation Recommended:</b>	10	Volts AC or DC
<b>Maximum:</b>	15	Volts AC or DC
<b>Input Impedance:</b>	$700 \pm 7$	Ohms
<b>Output Impedance:</b>	$700 \pm 10$	Ohms
<b>Insulation Impedance:</b>	$>2000$	Megaohms
<b>Deflection at Rated Capacity:</b>	$<0.4$	mm
<b>Weight:</b>	See Dimensions Table	kg
<b>Construction:</b>	Stainless Steel	
<b>Environmental Protection:</b>	IP67	
<b>Cable:</b>	3 Metre 4 Core Screened	

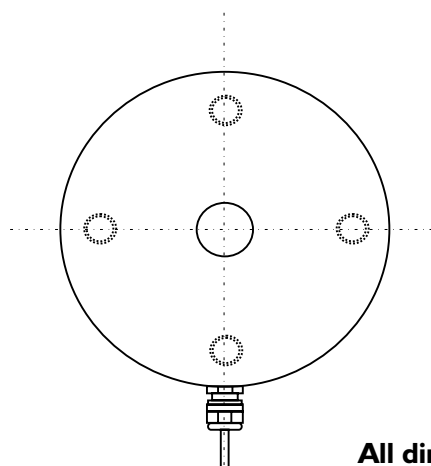
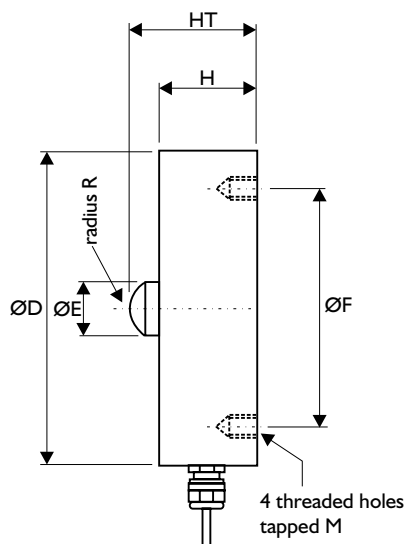

**All dimensions in mm**

CAPACITY (kgf)	ØD	ØE	ØF	H	HT	R	M	Weight
50, 100, 200, 500, 1000, 2000	59	10	42	21	25	50	M5 x 0.8 (7 deep)	0.35 kg
5000, 10,000, 20,000	98	20	72	35	40	150	M6 x 1.0 (8 deep)	2.3 kg
30,000	115	32	90	47.5	60	250	M12 x 1.75 (16 deep)	3.7 kg
50,000	150	44	125	65	80	400	M16 x 2.0 (20 deep)	7.5kg

